



# HOME of MAGNUM BOARD®

“The New Generation **GREEN** Building Material”

“Install It for Health-Install It for Life”

Providing Sheathing, Flooring, Roofing & Siding Building Materials

TECHNICAL BULLETIN No.:	062515-1324
Subject:	Installation Instructions for Magnum Interior & Exterior Walls and Ceilings
Issue / Revision Date:	August 6, 2018 – Revised May 04, 2026
Issue No.:	16

## 1.0 PURPOSE

- 1.1 To provide installation instructions for Magnum® Fiber Reinforced MgO Sheathing.
- 1.2 Tape relief edge Magnum Board® Sheathing is available for interior sheathing applications where joint finishing is specified prior to applying the selected finish.
- 1.3 All Magnum® MgO Building Materials are manufactured using the same formulation. All our building materials are certified for interior and exterior applications.

## 2.0 GENERAL

- 2.1 Always follow Magnum® Fiber Reinforced MgO Building Materials Storage and Handling Instructions.

## 3.0 RESPONSIBILITY

- 3.1 It is the responsibility of the installer to ensure that the framing to which the Magnum Board® Sheathing is affixed is square. If using wood framing, always be sure wood is dry before installing Magnum Board® Sheathing. If using wood framing, MBP recommends using kiln dried lumber to help reduce potential expansion and contraction.
- 3.2 AS is the case with any sheathing, out of square and unstable framing or installing Magnum Board® Sheathing over wood framing with excess moisture may lead to joint cracking due to stress.

- 3.3 If problems exist, notify the owner / general contractor prior to the installation of Magnum Board® Sheathing and insist on corrective action.

#### **4.0 MATERIAL HANDLING REQUIREMENTS**

- 4.1 Marshal or stage materials as close to the point of installation as possible. Ensure relative humidity is  $\leq 55\%$  before and during installation process. To minimize board expansion or contraction which could result in joint cracks, before installing Magnum Board® Sheathing, remove the packaging and allow the panels to acclimate to the room temperature and humidity for 48 hours. Replicating your finished room operating temperature and humidity conditions is ideal.
- 4.2 Always store Magnum Board® Sheathing® flat and protect it from weather and jobsite dirt before, during and after installation.
- 4.3 Always protect the corners of Magnum Board® building materials prior to and during installation.
- 4.4 **DO NOT STACK OTHER MATERIALS ON TOP OF MAGNUM BOARD® SHEATHING.**

#### **5.0 MATERIAL AND TOOL REQUIREMENTS**

- 5.1 Premium-grade, high performance, moisture cured, 1-component, polyurethane based non-sag, non-shrink elastomeric sealant / adhesive such as “Sikabond Construction Adhesive”, LOCTITE PL® PREMIUM® Construction Adhesive or equal.
- 5.2 Putty knife.
- 5.3 High quality joint compound
- 5.4 Fiba tape for cement board, 2” width
- 5.5 IF installed onto galvanized light gauge steel (LGS), primer pain or 2” wide painters taper, or equal. Reference sections 6.2.3 and 10.5

#### **6.0 INSTALLATION PROCEDURE**

- 6.1 CUTTING MAGNUM BOARD® SHEATHING
- 6.1.1 Use a carbide tipped scoring knife or a power saw equipped preferably with a cement board saw blade. We recommend using a T-square to help ensure cuts are straight and even.

- 6.1.2 Make circular cuts and irregular angle cuts with a Jig Saw Roto-Zip, Dremel, oscillating multi-tool or equivalent type power tool equipped preferably with a cement board bit or carbide tipped bit.

## **6.2 INSTALLING MAGNUM BOARD® SHEATHING**

- 6.2.1 Always start your project with proper framing ensuring studs are straight and square to allow for adequate fastening surface at adjoining walls and flat stress-free installation of Magnum Board® Sheathing
- 6.2.2 Always fasten Magnum Board® Sheathing to solid kiln dried wood or metal studding. Horizontal backer support may be used if necessary.
- 6.2.3 Before installing the first sheet of Magnum Board® Sheathing, and if your structure is light gauge steel, read section 10.5. After taking recommended action as outlined in 10.5, install the first sheet of Magnum Board® Sheathing or Magnum 111 vertical siding flush with the vertical stud to which it is being fastened. Reference diagram A.
- 6.2.4 Follow the fastener guideline below.
- 6.2.5 Install fasteners straight, not at an angle.
- 6.2.6 Apply a generous amount of the selected Sealant / Adhesive to the exposed edge of the installed sheet. Refer to Material Requirements section above and reference diagram B below.
- 6.2.7 Install the next sheet of Magnum Board® Sheathing butting joints together tightly. A small amount of Sealant / Adhesive” should squeeze to the surface along the entire seam. Reference diagram below.
- 6.2.8 Using a putty knife, remove excess Sealant / Adhesive from butt joint leaving a smooth “seamless” appearing surface between the two-(2) installed sheets of Magnum Board® Sheathing.
- 6.2.9 Clean putty knife after smoothing every joint to eliminate buildup of putty on the putty knife.
- 6.2.10 Countersink all fasteners unless otherwise instructed by manufacturer of product to be applied to Magnum Board® Sheathing as a final finish.

- 6.2.11 If fasteners are countersunk, using a putty knife, apply selected joint compound to all fastener countersinks ensuring the application is smooth and blends into the flat surface of the Magnum Board® Sheathing. This will help ensure a level “5” smooth painted surface finish.
- 6.2.12 If necessary to sand the fastener countersink areas on Magnum Board® Sheathing, use lightweight sandpaper to ensure a smooth finish for painting.
- 6.2.13 Always ensure Sealant / Adhesive is completely dry before sanding and applying final finish.

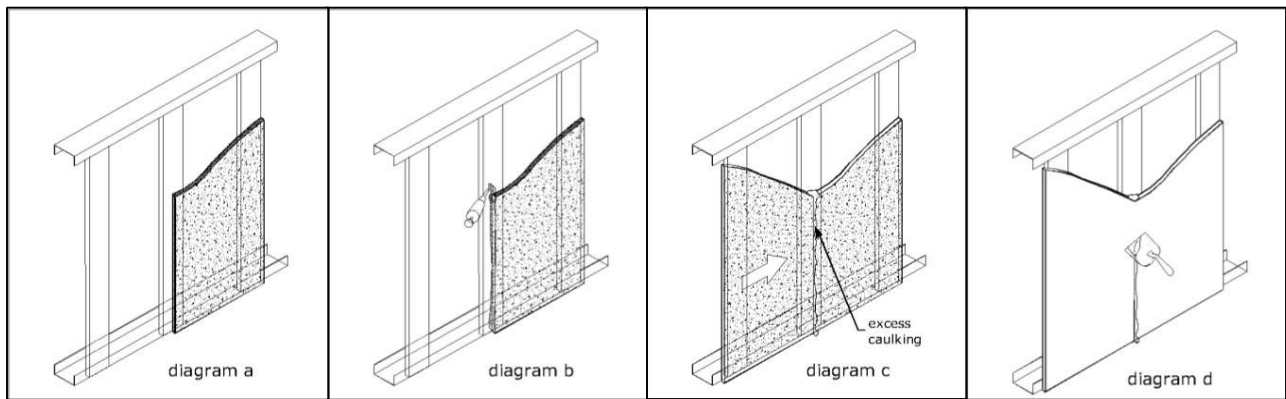

**6.3 INSTALLING MAGNUM BOARD® SHEATHING ON EXTERIOR WALLS WHERE FINAL FINISH IS SPECIFIED AS OTHER THAN PAINT**

- 6.3.1 Consult with your installer or the manufacturer of the product that is specified as your final finish seeking instructions on how to prep the fastener countersinks and joints to properly apply the specified final finish.

**6.4 INSTALLING MAGNUM BOARD® SHEATHING ON INTERIOR / EXTERIOR CEILINGS**

- 6.4.1 As with wall sheathing, always start with proper framing ensuring studs are straight and square to allow for adequate fastening surface at adjoining walls and flat stress-free installation of Magnum Board® Sheathing.
- 6.4.2 Ensure relative humidity is  $\leq 55\%$  before and during installation process.
- 6.4.3 When stalling Magnum Board® Sheathing to ceilings, use a panel lifter, “T” Brace or similar device as a safety measure to hold the Magnum Board® Sheathing panels in place while fastening.
- 6.4.4 Start with installing Magnum Board® Sheathing ceiling panels at right angles to joists.

- 6.4.5 Stagger butt end joints so joints do not extend across the ceiling. It is recommended that you not place a butt end next to a tapered end.
- 6.4.6 We recommend butt joints be staggered and not run seams lineally across the ceiling.
- 6.4.7 Always install long sides of Magnum Board® Sheathing to framing to achieve best stability and joint finishing.
- 6.4.8 Apply a generous amount of selected Sealant / Adhesive to the exposed edge of the installed sheet of Magnum Board® Sheathing. Refer to “Materials Required” section above.
- 6.4.9 Install next sheet of Magnum Board® Sheathing butting joints together tightly. A small amount of Sealant / Adhesive should squeeze to the surface along the entire seam. Remove this material with a putty knife.
- 6.4.10 Follow the fastener guideline below.
- 6.4.11 Slightly countersink each fastener to allow for proper finishing.
- 6.4.12 Refer to section “8” for joint finishing.

## **7.0 FASTENING**

- 7.1 General Fastening Information:
  - 7.1.1 Best: Stainless steel fasteners, especially when building in salt air and high humidity environments.
  - 7.1.2 Good: Ceramic coated fasteners such as Grabber Guard 1500 or equal..
  - 7.1.3 Magnum Board® Sheathing takes no responsibility if the installer uses anything, but the materials that are recommended herein.
- 7.2 Fastening with screws:
  - 7.2.1 Fastening to kiln dried wood studs with screws: Utilize a #6 or thinner shank, flat head fastener with high/low threads and a sharp drill point.

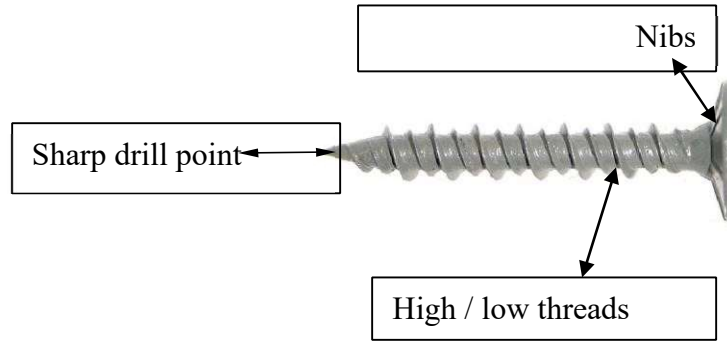

7.2.2 Fastening to metal, 18 gauge or heavier, with screws: Utilize a #8 shank flat head screw with nibs under the head for countersinking into the Magnum Board® Sheathing Sheathing®, and a self-drilling point for penetrating the light gauge metal.

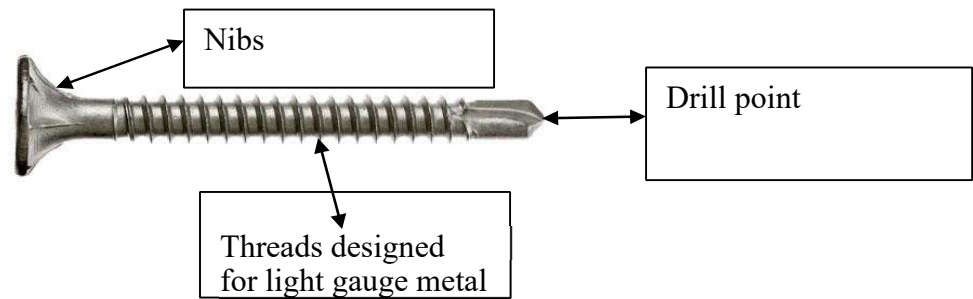

7.2.3 When fastening to light gauge materials lighter than 18 gauge, it may be necessary to utilize pneumatic fastening. Fasteners shown in 7.2.2 above may strip out lighter gauge studding prior to countersinking the head of the fastener into the Magnum Fiber Reinforced MgO sheathing.

7.3 Fastening with pneumatic pins.

7.3.1 Use hardened pins.

7.3.2 Pneumatic pressures vary depending on board thickness and stud material used. Always test pressures on a small sampling of Magnum Board® Sheathing to ensure proper set pressure based on countersinking needs.



7.4 Magnum Fiber Reinforced MgO Building Materials can be fastened direct to block. Check with your local fastener expert or call Magnum Fiber Reinforced MgO Building Materials, Tampa FL office for installation details.

7.5 Installing Fasteners:

7.5.1  $\geq 4$ " from corners.

7.5.2 Approximately 9/16" from the board edge.

7.5.3. 12" apart along perimeter edges and joist lines.

7.6 Fastener Expert in Project Locations

7.6.1 It is always a good idea to consult with your Engineer, Architect, and or a local fastener expert in the area where the project is located to ensure the correct fastener materials of construction are specified. Salt areas may require a fastener upgrade.

7.6.2 You may also consult Magnum's home office concerning correct fastener materials prior to the start of installation.

## 8.0 JOINT FINISHING

8.1 MBP recommends that Magnum Board® Sheathing be installed butt jointed; however, if Magnum Board® Sheathing is installed with a space between the joints, BASF states that "the optimal depth of a sealant joint should not exceed half the sheathing thickness." If the depth exceeds the thickness by more than one half, always fill the space with the appropriate backer rod prior to applying selected joint compound. If backer rod is not used and the entire cavity is not filled, as the joint compound dries it may sink resulting in a joint reveal or seam cracking.

8.2 Consult with your finished product manufacturer for instructions on preparing exterior butt joints prior to applying final finish to Magnum Board® Sheathing.

## 9.0 **BOARD SURFACE FINISHING**

- 9.1 Magnum Board® Sheathing is a fiber reinforced MgO Cement Board that can be finished with most any type of product including, but not limited to paint, lime and clay-based products, stone, brick Portland based and synthetic type stuccos and much more. **ALWAYS** consult with your finished material manufacturer / supplier for their updated application guidelines prior to beginning your project.
- 9.2 Prior to painting, always wipe down the surface to remove any dust and the water-based mold release used during manufacturing.

## 10.0 **IMPORTANT NOTES / PRECAUTIONS**

- 10.1 Following good material preservation and construction practices, Magnum® Fiber reinforced MgO Building Materials are not recommended for prolonged direct exposure to rain or weather. If the sheathing is exposed to moisture, allow it to dry on a flat surface before installing.
- 10.2 Always begin fastening at one side and proceed to fasten across the board to the other side to avoid stress.
- 10.3 Magnum® Fiber Reinforced MgO Building Materials are environmentally friendly, contain no formaldehyde or carcinogenic materials; however, a dust mask is always recommended during routing, cutting, and/or sanding operations. Refer to MBP MSDS for additional safety information.
- 10.4 In addition to following MBP's installation guidelines, installation must always comply with all applicable local, state, and federal codes and should also follow good installation practices.
- 10.5 When installing magnesium oxide sheathing over galvanized steel framing, chloride content in some MgO products can occasionally react with the metal—particularly in coastal regions, high-humidity environments, or other areas exposed to salt-laden air. This interaction can potentially affect the framing over time.
- Thanks to its proprietary low chloride (hybrid) formulation, Magnum Board® has not experienced reported cases of this type of reaction under normal installation conditions.

Nevertheless, as an added precaution, especially in corrosive environments, direct contact between the sheathing and light-gauge steel framing should be avoided.

A suitable separation barrier should be applied to the steel framing before installation.

Acceptable options include a minimum 1-mil coating of primer or an appropriate construction tape, such as fire tape or blue painter's tape. If tape is used, ensure that it is firmly adhered and continuous along the framing members.

10.6 **ALWAYS** follow finish manufacturers' recommendations for applying to Magnum Fiber Reinforced MgO Building Materials.

10.7. From time to time, Magnum Board® Sheathing Products may update their installation guidelines. It is the responsibility of the Architect and / or Installer to confirm they are designing and working with the latest guidelines available. Contact our Magnum Board® office to request the current installation guidelines before commencing your project.

## 11.0 **AVAILABLE PRODUCT DIMENSIONS**

11.1 Widths: 4' (1.2M)

11.2 Lengths: 8' (2.4M), 9' (2.7M), 10' (3.0M) and 12' (3.6M)

11.3 Thickness: 3mm to 20mm

11.4 Special order sizes are available within the above width and overall length dimensions.  
Call for pricing and delivery information.

## 12.0 **SQUARE EDGE PROFILE**





**14.0 TAPE RELIEF EDGE PROFILE**



**15.0 TONGUE AND GROOVE PROFILE**



**16.0 SHIP LAP PROFILE**



**CAUTION:**

Because materials expand and contract at different rates and under different conditions, no one, including Magnum Fiber Reinforced MgO Building Materials, can guarantee crack free joints. The reports we have received from our customers indicate many types of joint compounds have been used successfully.

Customers do tell us they have had good luck using “fiba tape” joint tape, designed especially for use with cement based sheathing materials. We are happy to discuss with you the joint compound you intend to use and provide to you any feedback we may have received on the specific type; and, we are happy to tell you what our customers have had success with in the pass. Please call us at your convenience.

Please visit our web-site at [www.magnumbp.com](http://www.magnumbp.com) to view more information about this “**GREEN**” sheathing material including install guidelines and pictures of installations around the World.

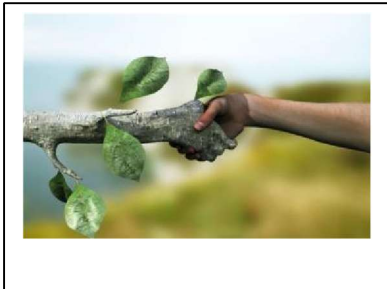

On Behalf of  
Mother - Nature  
**THANK YOU**



**“GOTTA GO GREEN”**